



ROYAL SWISS HOUSING | SWISS TOWN HOUSES

HRL
HABIB RAFIQ (PVT.) LTD.



Sustainable Living



ROYAL SWISS HOUSING | SWISS TOWN HOUSES

HRL
HABIB RAFIQ (PVT.) LTD.

SWISS TOWN HOUSES

Luxury Living | Elite Investment | Timeless Design

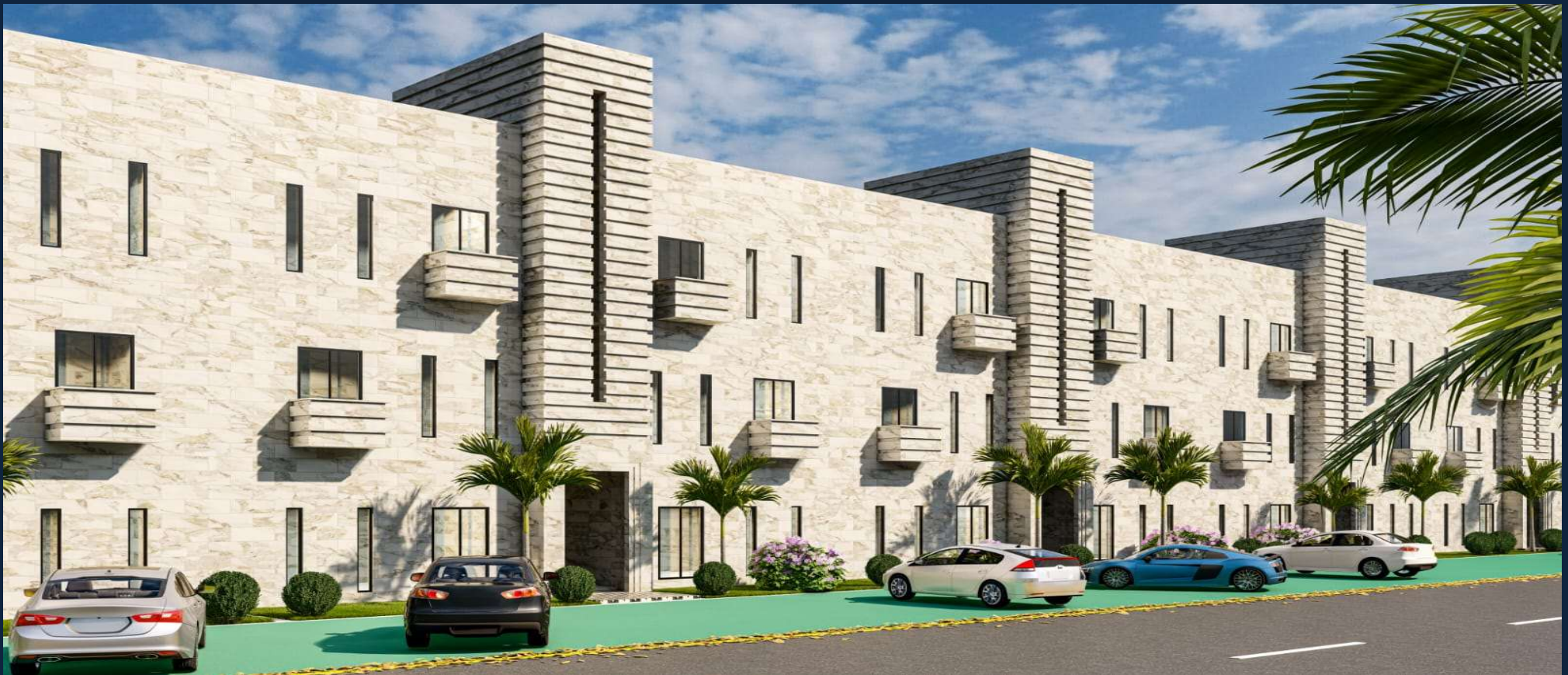

Sustainable Living



A Statement of Prestige

Swiss Town Houses redefine executive living within Royal Swiss Housing. Engineered by Habib Rafiq (Pvt.) Ltd., the project reflects structural excellence, architectural balance, and long-term investment positioning.

Swiss Town Houses represent refined architecture and elevated living standards. Designed with modern precision and premium aesthetics, this development delivers both residential comfort and high-value investment potential.

Engineered by Habib Rafiq (Pvt.) Ltd. Habib Rafiq (Pvt.) Ltd. will undertake the construction of Swiss Town Houses in accordance with its established quality standards, engineering excellence, and professional supervision protocols.

In addition, the project will be maintained free of cost for one (1) year after possession, ensuring smooth operations and quality assurance for residents.

Prime Executive Block Location

Positioned directly on Main Boulevard.

Immediate access to Commercial Area and Community Park.

Executive Block placement enhances appreciation, rental demand.

Premium surroundings.

Sustainable Living



Design Philosophy

A bold fusion of modern structure and elegant simplicity:

- Symmetrical & Clean Elevation
- Premium Layout Optimization
- Abundant Natural Light
- Functional Luxury Planning
- Exterior Covered with Travertine (Modern Architecture Stone) Lifetime Maintenance Free
- Contemporary 3-Storey Architectural Form
- 816 SFT Covered Area Per Floor
- Premium Layout Optimization
- 2 Bedrooms with Attached Baths
- Elegant Lounge & Dining Area
- Modern Kitchen
- Private Lawn / Balcony (Selected Floors)

Every element reflects balance, proportion, and sophistication.

Sustainable Living



ROYAL SWISS HOUSING | SWISS TOWN HOUSES

HRL
HABIB RAFIQ (PVT.) LTD.

Architectural Floor Plan Collection

Signature Unit Layout

2 Bedroom Executive Town House

🏠 2 Spacious Bedrooms

🛁 Attached Modern Bathrooms

👑 Elegant Lounge

🍽️ Dedicated Dining Area

🔍 Modern Kitchen

🌿 Private Lawn / Balcony (Selected Floors)

🏠 Central Stair Lobby Access

A perfect blend of comfort and privacy for modern families.

Sustainable Living



ROYAL SWISS HOUSING | SWISS TOWN HOUSES



Ground Floor – 816 sft



GROUND FLOOR PLAN
Covered Area= 816 sft (per town house)

Sustainable Living



ROYAL SWISS HOUSING | SWISS TOWN HOUSES

HRL
HABIB RAFIQ (PVT.) LTD.

First Floor – 816 SFT



FIRST FLOOR PLAN
Covered Area= 816 sft (per town house)

Sustainable Living



ROYAL SWISS HOUSING | SWISS TOWN HOUSES

HRL
HABIB RAFIQ (PVT.) LTD.

Second Floor – 816 \$FT

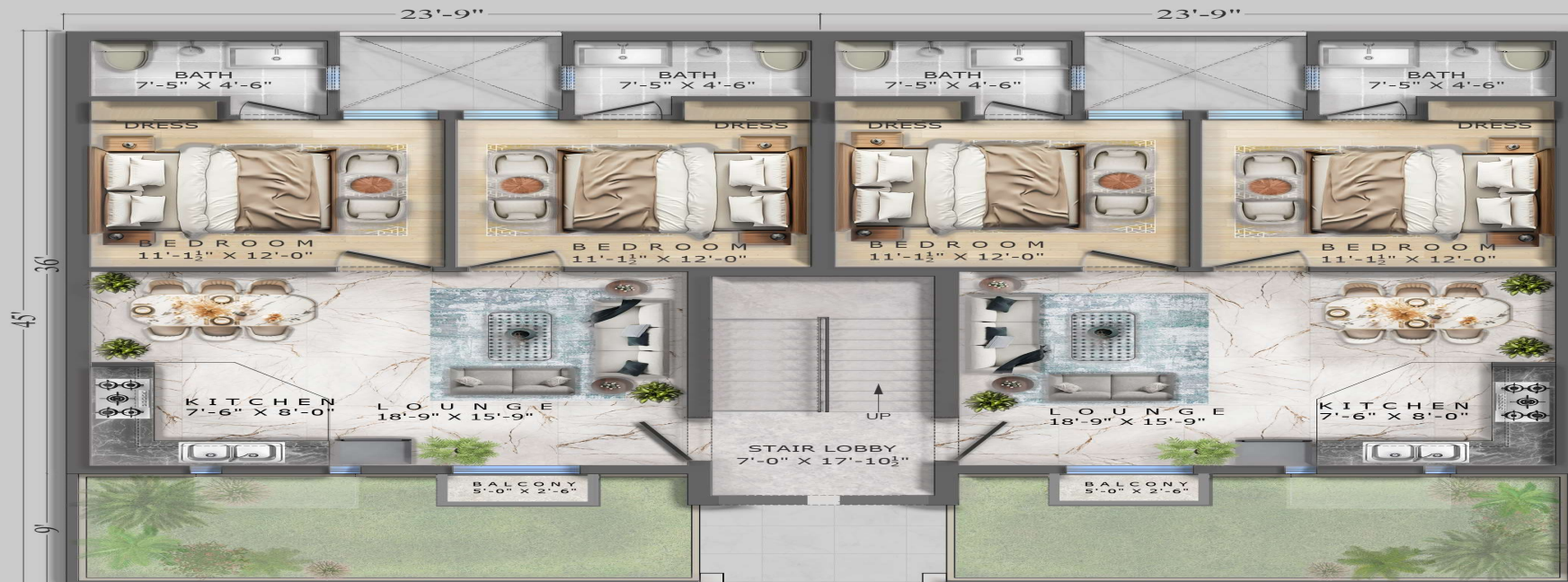

SECOND FLOOR PLAN
Covered Area= 816 sft (per town house)

Sustainable Living



Roof / Terrace Plan



TOP FLOOR PLAN
Covered Area= 308.25 SFT

Sustainable Living



ROYAL SWISS HOUSING | SWISS TOWN HOUSES

HRL
HABIB RAFIQ (PVT.) LTD.

Lifestyle & Investment Advantages

- Landscaped Front Lawns
- Secure Community Environment
- High Rental Demand Potential
- Strong Capital Appreciation Outlook
- Free Maintenance by Habib Rafiq Pvt. Ltd for 1 Year

An Opportunity Reserved for Visionaries

Own a residence that reflects prestige, location advantage, and intelligent capital growth.

Lifestyle Meets Legacy

Designed for modern families who value comfort, privacy, and functionality.

Built for investors who understand long-term wealth creation.

Live well. Invest wisely.

Limited Inventory. Unlimited Potential

Opportunities don't wait. Premium inventory always rewards early decision-makers. Secure before revision. Benefit before escalation

Sustainable Living



ROYAL SWISS HOUSING | SWISS TOWN HOUSES



Launch Prices (Valid Uptil 15 April 2026)

Membership Fee : 50,000 (Non-Refundable)

Payable in 3 equal monthly installments

Merging of Plot Payments Acceptable

- Ground Floor – 5,500,000/-
- First Floor – 5,000,000/-
- Second Floor – 4,500,000/-

Revised Rates After 15 April 2026

Payable in 3 equal monthly installments

Membership Fee : 50,000 (Non-Refundable)

- Ground Floor – 6,000,000/-
- First Floor – 5,500,000/-
- Second Floor – 5,000,000/-

Balloting Day (14 February 2026) Exclusive Privileges

- Refundable Booking Token – 10,000/-
- Flat Discount – 100,000/-
- Possession Within 1 Year or 500,000/- Appreciation Guarantee

Sustainable Living



ROYAL SWISS HOUSING | SWISS TOWN HOUSES

HRL
HABIB RAFIQ (PVT.) LTD.

Money Back Commitment

-  Possession Within 1 Year
- If possession is not delivered within one year, the buyer may return the townhouse and claim the full paid amount along with 500,000/- appreciation.
- Confidence. Transparency. Commitment.

For Sales & Priority Booking

Contact

- Multan Office: House No. 253-D, Northern Bypass, Near Nigana Chowk Multan
- Email: info@royalswiss.com
- Phone: [+92-31-111-444-32](tel:+92-31-111-444-32)
- Phone: [+92 61 621 6008/9](tel:+92-61-621-6008-9)
- Open: Mon - Sat / 9:00 AM - 6:00 PM

Or

Contact Our Authorized Sales Representative

Sustainable Living